

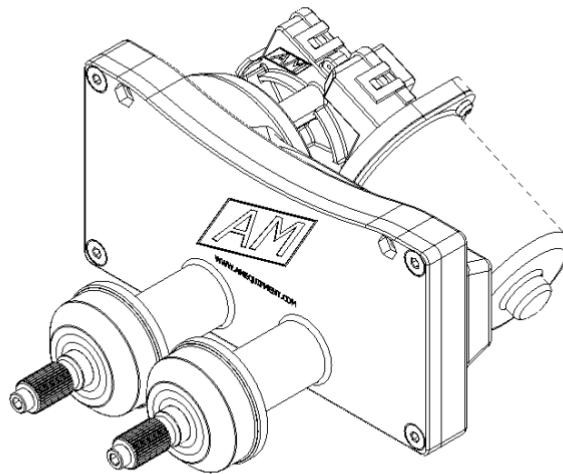

2D Wiper System Installation Instructions



Note: It is very important that the wiper motor remain in the parked position, do not start the wiper system until the arms and blade are installed.

1. Visually inspect the 2D Wiper System for shipping/storage damage & for completeness:
 - a. Nothing is broken or disconnected.
 - b. No slop in the pivot shafts.
 - c. Pivot shaft hardware, mounting spacers, & bulkhead fittings (optional) are on-hand.
2. Mark location of pivot shaft holes.
 - a. Refer to the wipe pattern layout (if applicable) for the location of the pivot holes with relation to the centerline and from the edge of the glass.
 - b. The center-to-center distance of the pivot shafts is 60.0 mm [2.36 in].
3. Drill the required holes using a 31.0 mm [1.25 in] hole saw, or equivalent, perpendicular to the glass plane.
4. Fit the 2D Wiper System with the pivot shafts protruding through the drilled holes (see figure 1).

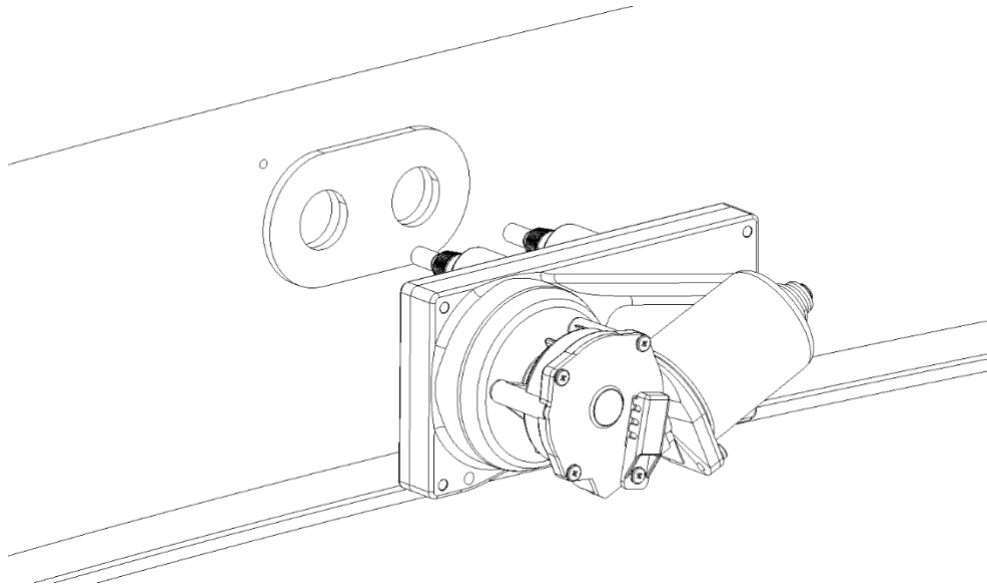

Figure 1

5. Install the fiber washers, PN 407-1112 (see figure 2).

6. Install the supplied nuts (see figure 2), and torque to 27.0 ± 2 Nm [20 ± 1.5 ft-lb] (socket available for purchase, PN 344-1003).
7. For proper seal fitment, refer to “Seals and Spacers Reference” on the AME website.

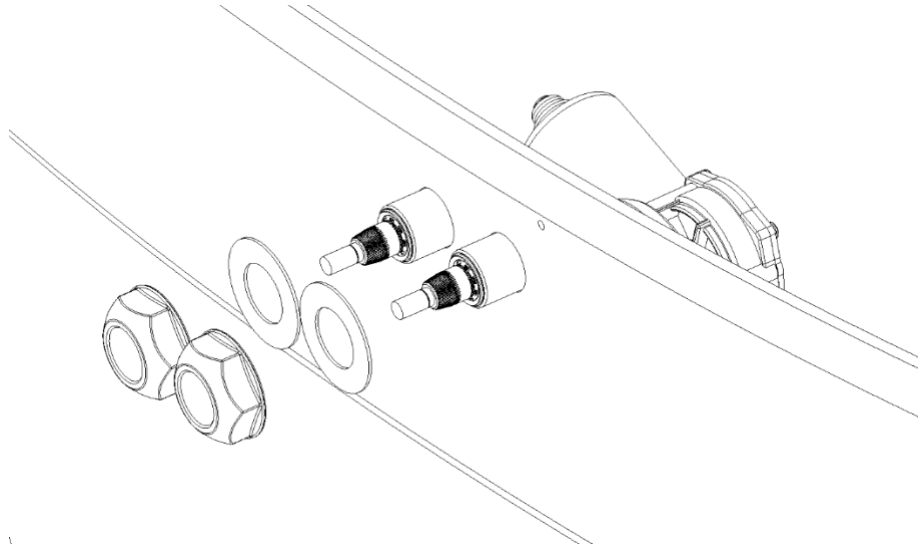

Fig. 2.

Note:

Ensure wiper switch is in off position before connecting wire harness to motor assembly.

8. Plug the wire harness into the motor connector.
9. Locate and drill a 10mm hole for the bulkhead fitting.
10. Install the bulkhead fitting into the drilled hole (see figure 3).
11. Connect the washer hose from the washer fluid bottle to the bulkhead fitting (see figure 3).

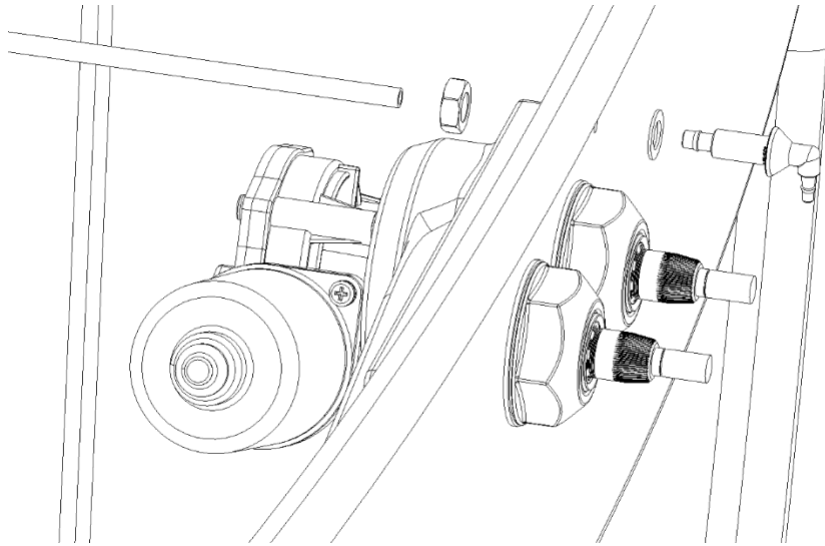

Fig. 3.

12. Install wiper blade onto wiper arm (see figure 4).

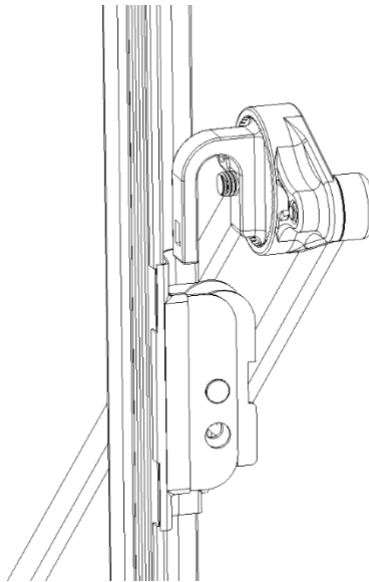

Fig. 4.

13. Install the arm/blade assembly onto the pivot shafts aligning the assembly to the desired park position. Reference the wiper layout for the park position. (if applicable)

Note:

For 2D Wiper Systems with washer hoses attached to the wiper arms, leave enough hose so that the arm will not pull it off or kink the hose during operation.

14. Install the pivot shaft nuts to secure the arms.

- a. For Tapered Knurl shafts, tighten the acorn nuts PN 407-1010 to 8 ft-lbs [11 Nm]
 - b. For M10 DIN shafts, tighten both nuts PN 414-2042 to 25 ft-lbs [34 Nm]
 - c. For HD shafts (Straight Spline), tighten both SHC screws PN 414-1205 to 7 ft-lbs [9 Nm]
15. Connect washer fluid hose from wiper arm to the bulkhead fitting (wet arms only).
16. Operate the 2D Wiper Systems on low and high speeds on wet glass with the vehicle running. (The vehicle must be running to ensure that the wiper motor is at the proper voltage.)
17. Verify that the sweep pattern is correct and parked in the appropriate location. Wiper blades must not hit any of the moldings. If the sweep pattern is incorrect, or the blades hit the molding, remove the black cap nuts, PN 407-1010, and reposition the arms again.
18. The system is now properly installed. If there are any concerns or questions, call 541-327-1546 for technical assistance.

